

Spring plungers with slot and thrust pin, stainless steel

Item description/product images



Description

Material:

Sleeve 1.4305.

Thrust pin 1.4034.

Spring 1.4310.

Version:

Bright.

Thrust pin hardened.

Drawings

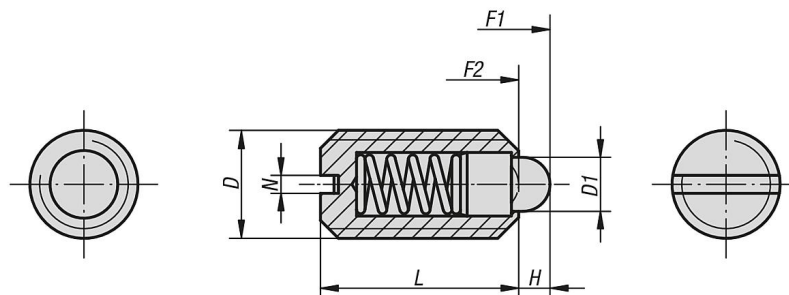

Overview of items

Spring plungers with slot and thrust pin, standard spring force

Order No.	Main material	D	D1	H	L	N	Spring force initial pressure F1 approx. N	Spring force final pressure F2 approx. N
K0314.04	stainless steel	M4	1,8	1,5	9	0,6	6	20
K0314.20	stainless steel	M20	10	6,5	30	2,5	60	120
K0314.05	stainless steel	M5	2,4	2	12	0,8	6	20
K0314.06	stainless steel	M6	2,7	2	14	1	7	20
K0314.08	stainless steel	M8	4	2	16	1,2	15	30
K0314.10	stainless steel	M10	4,5	2,5	19	1,6	20	35
K0314.12	stainless steel	M12	6	3,5	22	2	30	55
K0314.16	stainless steel	M16	8,5	4,5	24	2,5	45	100
K0314.104	stainless steel	M4	1,8	1,5	9	0,6	3	10
K0314.105	stainless steel	M5	2,4	2	12	0,8	3	10
K0314.106	stainless steel	M6	2,7	2	14	1	4	10
K0314.110	stainless steel	M10	4,5	2,5	19	1,6	9	16
K0314.112	stainless steel	M12	6	3,5	22	2	14	26
K0314.116	stainless steel	M16	8,5	4,5	24	2,5	22	50
K0314.108	stainless steel	M8	4	2	16	1,2	7	15
K0314.120	stainless steel	M20	10	6,5	30	2,5	30	60
K0314.205	stainless steel	M5	2,4	2	12	0,8	9	25
K0314.208	stainless steel	M8	4	2	16	1,2	22	43
K0314.210	stainless steel	M10	4,5	2,5	19	1,6	20	54
K0314.212	stainless steel	M12	6	3,5	22	2	36	94
K0314.206	stainless steel	M6	2,7	2	14	1	11	25
K0314.216	stainless steel	M16	8,5	4,5	24	2,5	60	110

Spring plungers with slot and thrust pin, light spring force

Spring plungers with slot and thrust pin, stainless steel

Overview of items

Order No.	D	D1	H	L	N	Spring force initial pressure F1 approx. N	Spring force final pressure F2 approx. N
K0314.104	M4	1,8	1,5	9	0,6	3	10
K0314.105	M5	2,4	2	12	0,8	3	10
K0314.106	M6	2,7	2	14	1	4	10
K0314.110	M10	4,5	2,5	19	1,6	9	16
K0314.112	M12	6	3,5	22	2	14	26
K0314.116	M16	8,5	4,5	24	2,5	22	50
K0314.108	M8	4	2	16	1,2	7	15
K0314.120	M20	10	6,5	30	2,5	30	60

Spring plungers with slot and thrust pin, reinforced spring force

Order No.	D	D1	H	L	N	Spring force initial pressure F1 approx. N	Spring force final pressure F2 approx. N
K0314.205	M5	2,4	2	12	0,8	9	25
K0314.208	M8	4	2	16	1,2	22	43
K0314.210	M10	4,5	2,5	19	1,6	20	54
K0314.212	M12	6	3,5	22	2	36	94
K0314.206	M6	2,7	2	14	1	11	25
K0314.216	M16	8,5	4,5	24	2,5	60	110