

Latch Toggle Clamp

Part No. GH-40380-RSS



Product Description

Stainless Steel Safety Lock Latch
Toggle Clamp Size 3400daN

Key Features

Overall Height: 94mm
Clamp Length: 187.7mm
Catch Plate Width: 79.4mm
Holding Force: 3400daN

Other Features

Weight: 1.61Kg
Safety Lock

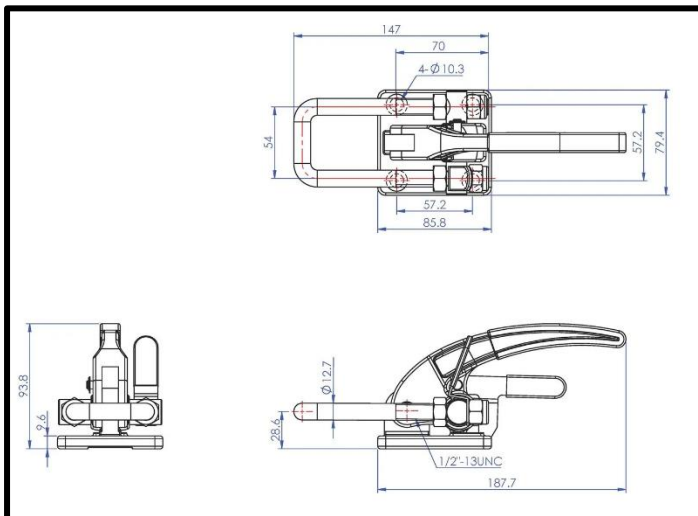

Material

Toggle Clamp: 304 Stainless Steel
U Bar: 304 Stainless Steel
Latch Plate: 304 Stainless Steel

What's In The Bag?

Toggle Clamp: GH-40380-RSS
Latch Plate: GH-40370-LPSS
U Bar: GH-40380-UBSS



goodhanduk.co.uk

01908 221 151