

# Vertical Toggle Clamp

Part No. GH-10250

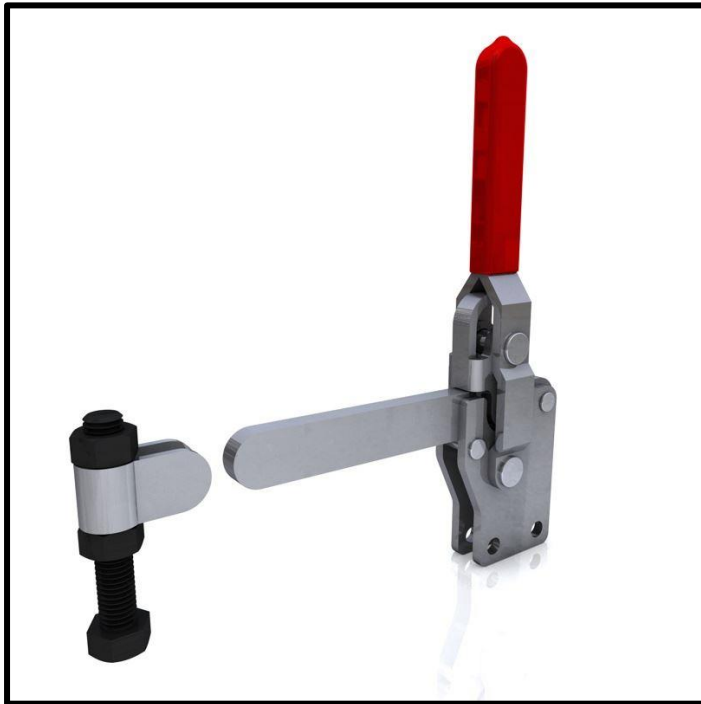

## Product Description

Vertical Toggle Clamp Straight  
Base Solid Arm Size 450Kg

## Key Features

Overall Height: 242mm  
Underarm Height: 66.9mm  
Arm Length: 125mm  
Holding Force: 450Kg

## Other Features

Arm Opens: 103°  
Handle Opens: 63°  
Weight: 1.23Kg

## Material

Clamp: Zinc Plated Mild Steel  
Spindle: Zinc Plated Mild Steel  
Handle: uPVC

## What's In The Bag?

GH-10250: Toggle Clamp  
SA-121017: M12x100mm Zinc Plated Steel  
Spindle With Nuts  
BR-120: Bolt Retainer For M12 Spindle

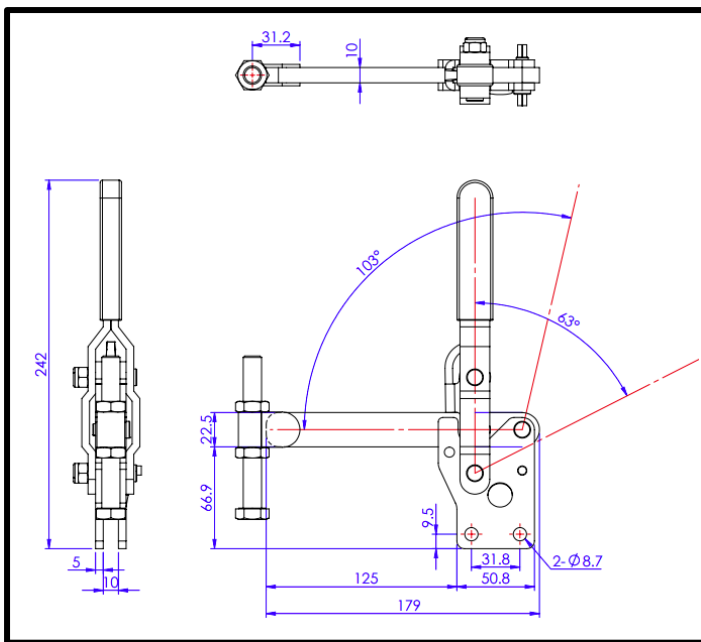

[goodhanduk.co.uk](http://goodhanduk.co.uk)

01908 221 151