

Vent screws with check valve

Item description/product images

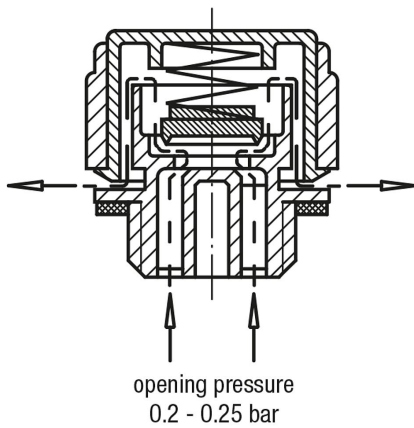

Operating principle



Description

Material:

Housing and cap thermoplastic polyamide 66.
Spring stainless steel.
Lift disc and flat seal rubber (NBR).

Version:

Housing black.
Cap red.

Note:

Opening pressure 0.20 – 0.25 bar.

Temperature range:

Temperature resistant with oil up to 100°C.

Drawing reference:

- 1) flat seal
- 2) lift disc
- 3) cap

Drawings

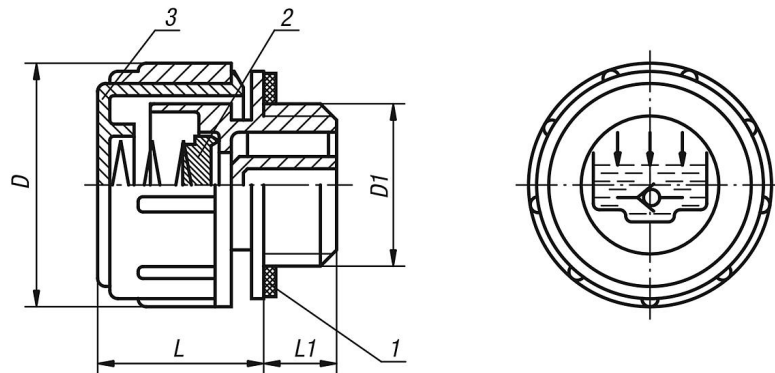

Overview of items

Vent screws with check valve

| Order No. | D | D1 | L | L1 |
|-------------|----|------|----|----|
| K0459.30014 | 30 | G1/4 | 21 | 10 |
| K0459.30038 | 30 | G3/8 | 21 | 10 |
| K0459.30012 | 30 | G1/2 | 21 | 10 |

