

# Vertical Toggle Clamp

Part No. GH-12055

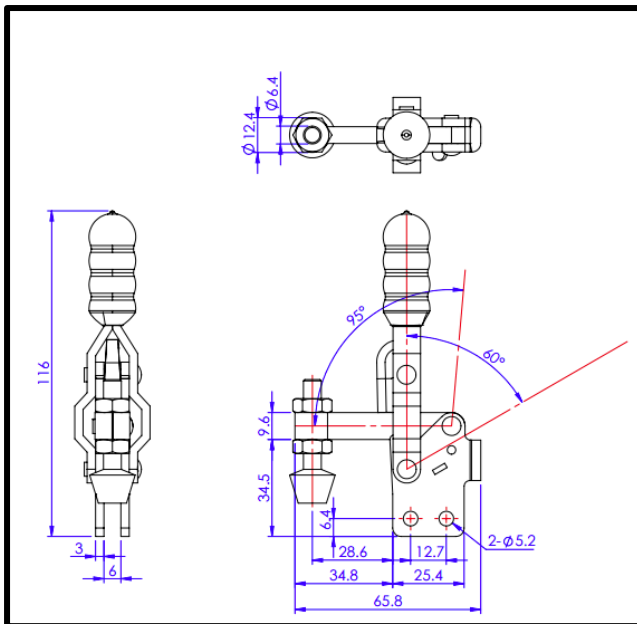
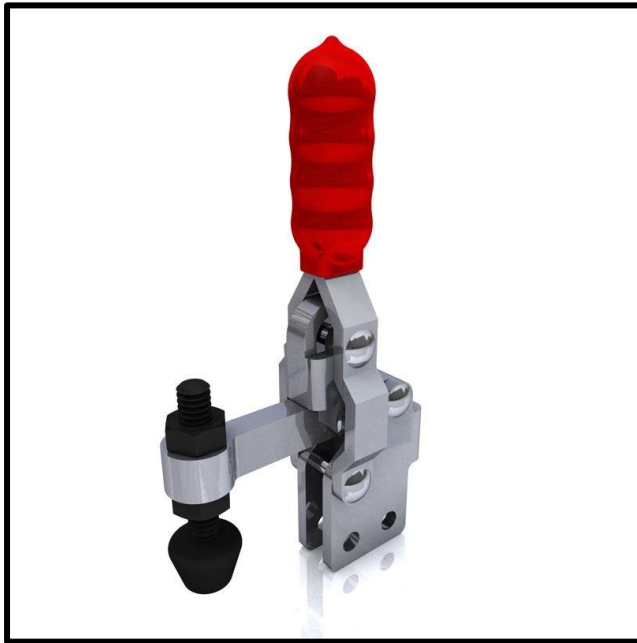

## Product Description

Vertical Toggle Clamp Straight  
Base Fixed Arm Size 91Kg

## Key Features

Overall Height: 116mm  
Underarm Height: 34.5mm  
Arm Length: 28.6mm  
Holding Force: 91Kg

## Other Features

Arm Opens:  $95^\circ$   
Handle Opens:  $60^\circ$   
Weight: 0.16Kg

## Material

Clamp: Zinc Plated Mild Steel  
Spindle: Neoprene Tipped Steel  
Handle: uPVC

## What's In The Bag?

GH-12055: Toggle Clamp  
FC-064410: M6x44mm Zinc Plated Steel Spindle  
With Nuts



[goodhanduk.co.uk](http://goodhanduk.co.uk)

01908 221 151