

Latch Toggle Clamp
Part No. GH-40323-SS

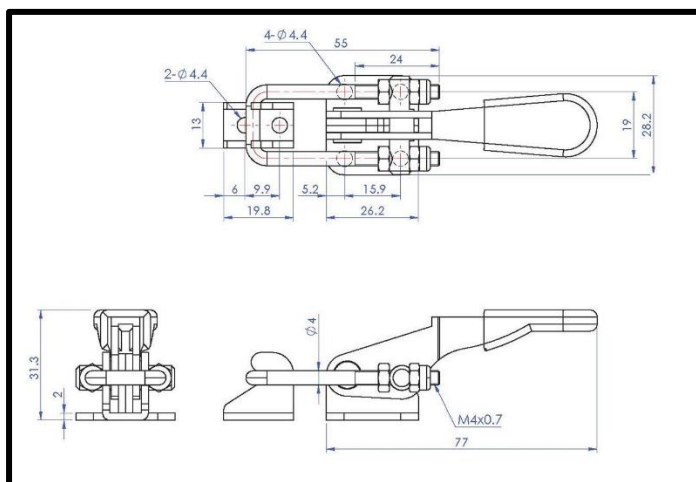

Product Description

Stainless Steel Latch Clamp With
Latch Plate Size 163daN

Key Features

Overall Height: 31.3mm
Clamp Length: 77mm
Catch Plate Width: 13mm
Holding Force: 163daN

Other Features

Weight: 0.07Kg

Material

Toggle Clamp: 304 Stainless Steel
U Bar: 304 Stainless Steel
Latch Plate: 304 Stainless Steel

What's In The Bag?

GH-40323-SS: Toggle Clamp
GH-40323-LPSS: Latch Plate
GH-40323-UBSS: U Bar