

Vertical Toggle Clamp

Part No. GH-11501-B

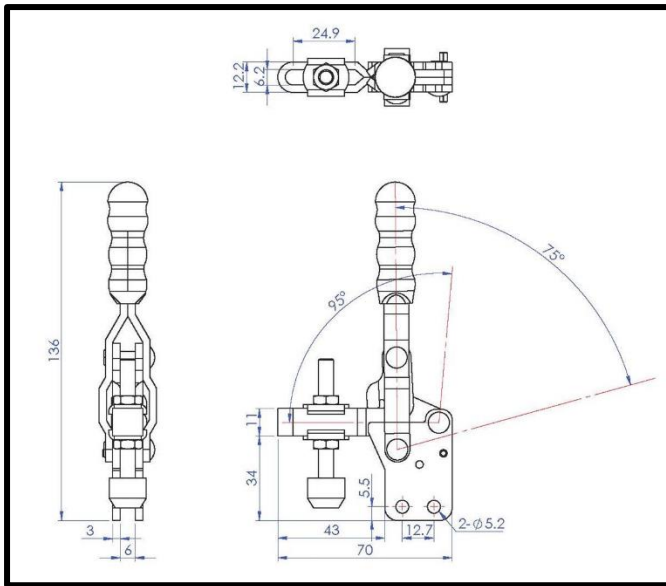
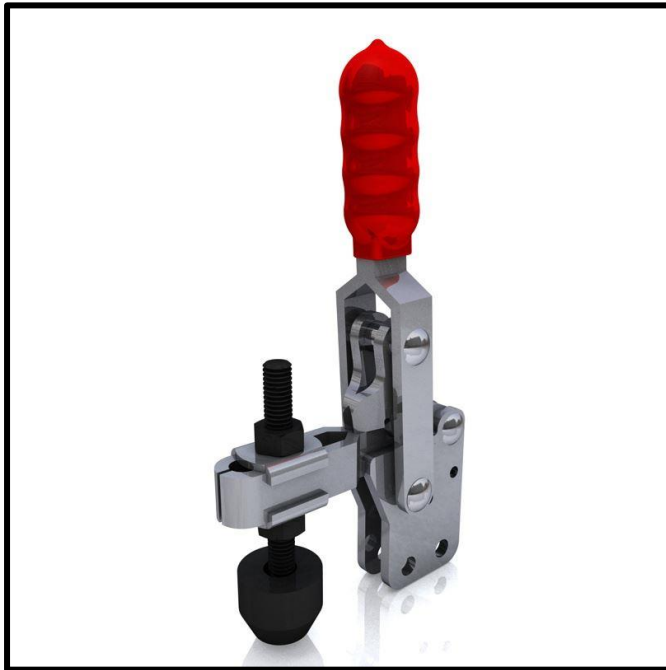

Product Description

Vertical Toggle Clamp Straight
Base Slotted Arm Size 150Kg

Key Features

Overall Height: 136mm
Underarm Height: 34mm
Arm Length: 43mm
Holding Force: 150Kg

Other Features

Arm Opens: 95°
Handle Opens: 75°
Weight: 0.19Kg

Material

Clamp: Zinc Plated Mild Steel
Spindle: Zinc Plated Mild Steel
Handle: uPVC
Neoprene Cap: Neoprene

What's In The Bag?

GH-11501-B: Toggle Clamp
SA-065010: M6x50mm Zinc Plated Steel Spindle
With Nuts
NC-06: Neoprene Cap For M6 Spindle
2x FW-142: Flanged Washers for M6 Spindle



goodhanduk.co.uk

01908 221 151