

Ball transfer units with solid steel housing

Item description/product images



Description

Material:

Steel electro zinc-plated.

Note:

Ball transfer units with solid housings remain functional even under heavy impact loads and extreme conditions.

They have a felt seal to protect against dirt.

Drawing reference:

- 1) load ball
- 2) bearing balls

Form B: cap and housing electro zinc-plated, balls steel

Form C: cap and housing electro zinc-plated, balls stainless steel

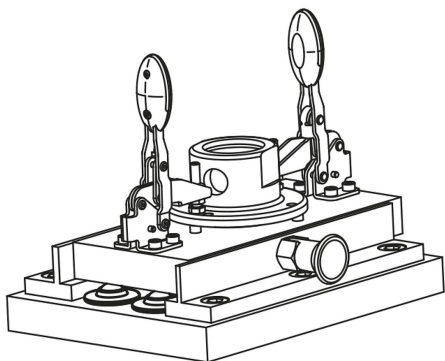

Ball transfer units with solid steel housing

Drawings

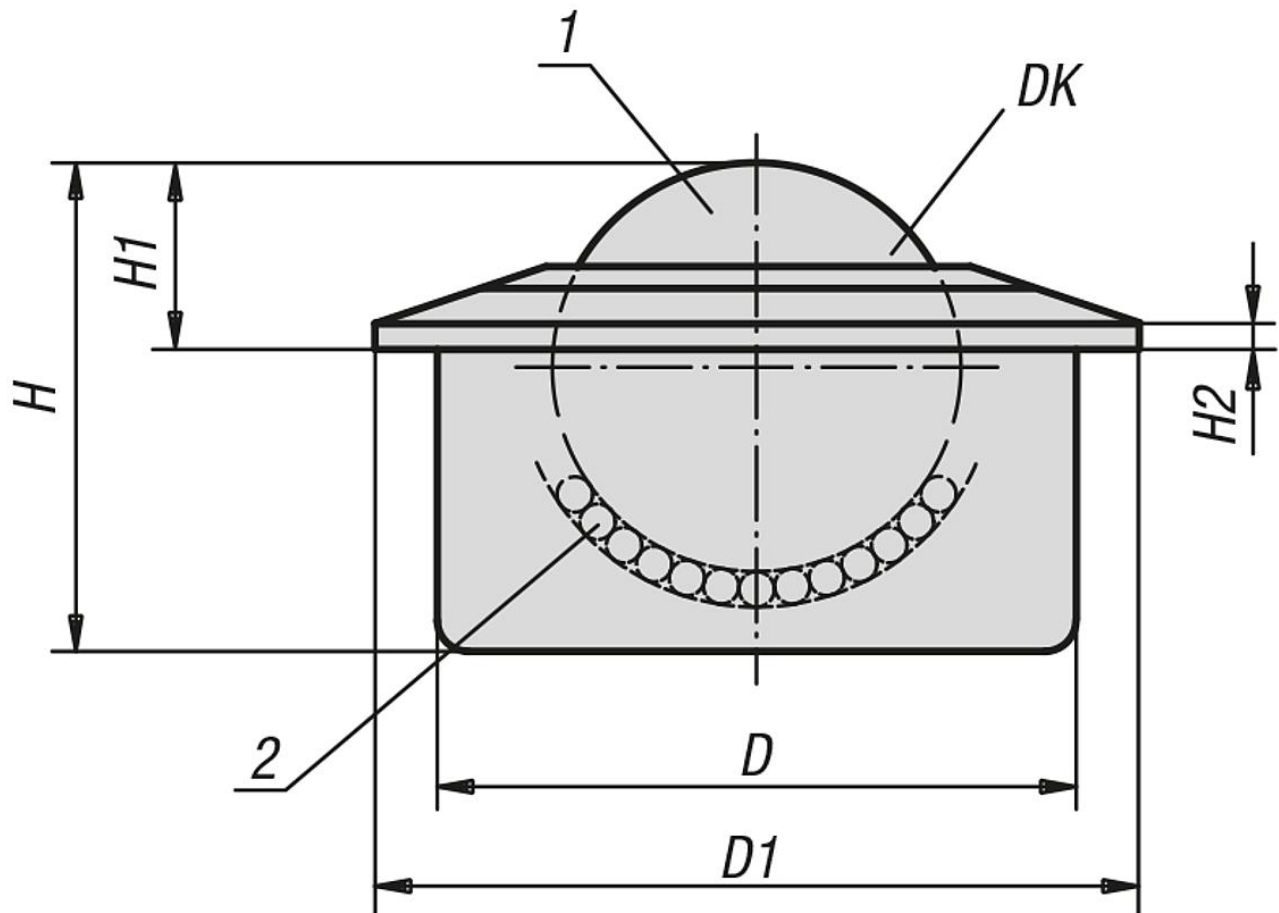

Overview of items

Ball transfer units with solid steel housing

| Order No. | Form | DK | D | D1 | H | H1 | H2 | Load rating C (N) | Suitable tolerance ring |
|-----------|------|------|---------|-----|------|------|----|-------------------|-------------------------|
| K0763.160 | B | 57,1 | 100±0,1 | 117 | 77,5 | 29,5 | 5 | 15000 | K0766.100 |
| K0763.260 | C | 57,1 | 100±0,1 | 117 | 77,5 | 29,5 | 5 | 10000 | K0766.100 |