

# Push-Pull Toggle Clamp

Part No. GH-30619M

**GH GoodHand UK**



## Product Description

Push Pull Toggle Clamp Plunger  
Stroke 77.8mm Size 2273Kg

## Key Features

Overall Height: 237mm  
Length: 272mm  
Stroke: 77.8mm  
Holding Force: 2273Kg

## Other Features

Arm Opens: 183°  
Weight: 3.6Kg

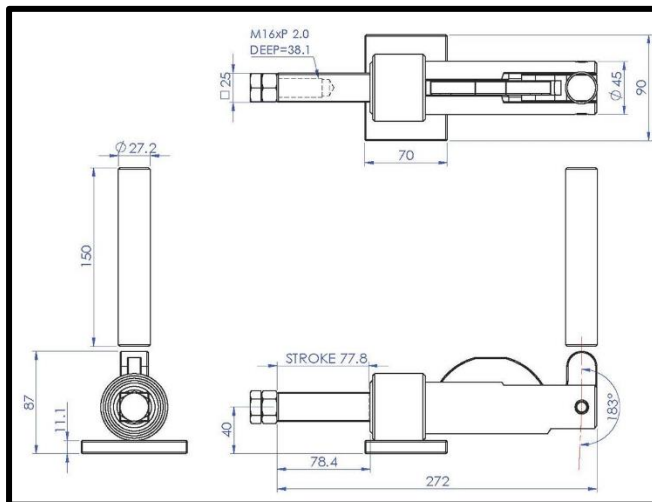

## Material

Toggle Clamp: Zinc Plated Mild Steel  
Base: Zinc Plated Mild Steel  
Spindle: Zinc Plated Mild Steel  
Handle: Zinc Plated Mild Steel

## What's In The Bag?

GH-30619M: Toggle Clamp  
SA-165020: M16x50mm Zinc Plated Steel Spindle  
With Nut  
Handle  
Clamp Base

**GH GoodHand UK**

[goodhanduk.co.uk](http://goodhanduk.co.uk)

01908 221 151