

Latch Toggle Clamp

Part No. GH-40341-SS

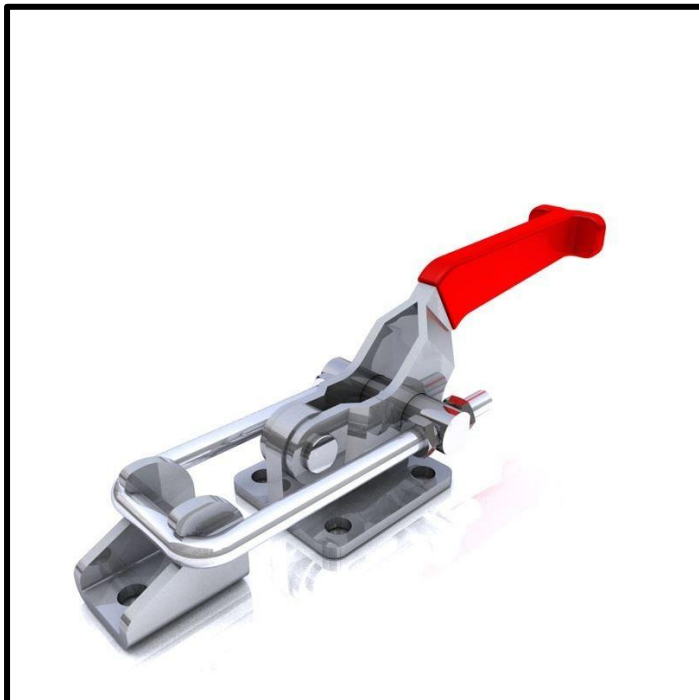

Product Description

Stainless Steel Latch Clamp With Latch Plate Size 900daN

Key Features

Overall Height: 76.1mm
Clamp Length: 171.8mm
Catch Plate Width: 30.2mm
Holding Force: 900daN

Other Features

Weight: 0.68Kg

Material

Toggle Clamp: 304 Stainless Steel
U Bar: 304 Stainless Steel
Latch Plate: 304 Stainless Steel

What's In The Bag?

Toggle Clamp: GH-40341-SS
Latch Plate: GH-40341-LPSS
U Bar: GH-40341-UBSS

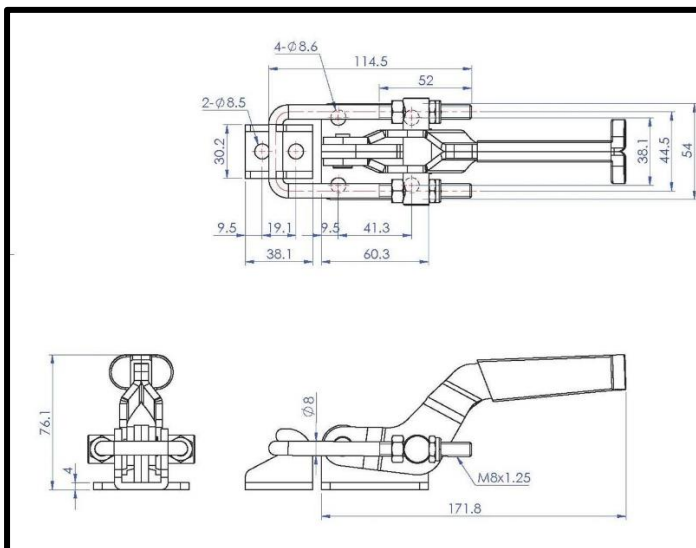

goodhanduk.co.uk

01908 221 151