

Levelling feet with hex. base

Item description/product images



Description

Material:
Polyethylene.
Screw, steel.

Note:
Levelling feet with hexagonal base. Rigid version.

Drawings

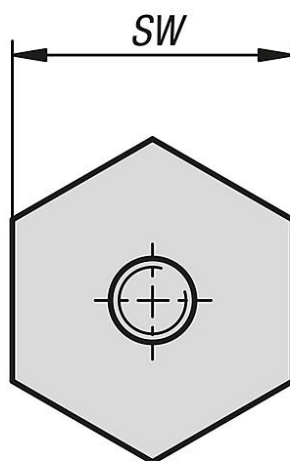
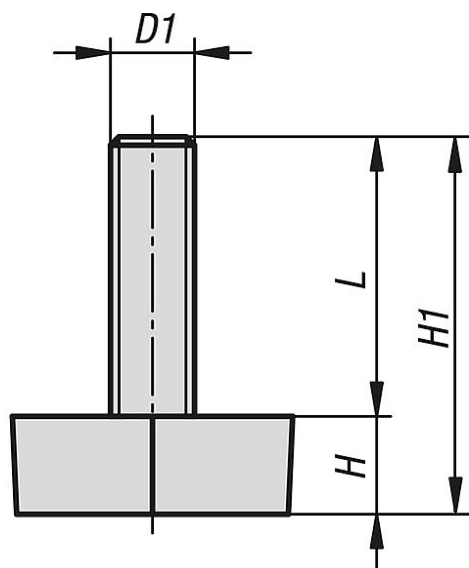

Overview of items

Levelling feet with hex. base

Levelling feet with hex. base

Overview of items

Order No.	D1	H	H1	L	SW	Load rating max. kN (static load only)
K0676.2006X020	M6	7	27	20	20	1,5
K0676.2006X030	M6	7	37	30	20	1,5
K0676.2006X040	M6	7	47	40	20	1,5
K0676.2006X050	M6	7	57	50	20	1,5
K0676.2008X020	M8	7	27	20	20	3
K0676.2008X030	M8	7	37	30	20	3
K0676.2008X040	M8	7	47	40	20	3
K0676.2008X050	M8	7	57	50	20	3
K0676.2506X020	M6	7,5	27,5	20	25	1,5
K0676.2506X030	M6	7,5	37,5	30	25	1,5
K0676.2506X040	M6	7,5	47,5	40	25	1,5
K0676.2506X050	M6	7,5	57,5	50	25	1,5
K0676.2508X020	M8	7,5	27,5	20	25	3
K0676.2508X030	M8	7,5	37,5	30	25	3
K0676.2508X040	M8	7,5	47,5	40	25	3
K0676.2508X050	M8	7,5	57,5	50	25	3
K0676.2510X020	M10	7,5	27,5	20	25	4
K0676.2510X030	M10	7,5	37,5	30	25	4
K0676.3008X020	M8	8	28	20	30	3
K0676.3008X030	M8	8	38	30	30	3
K0676.3008X040	M8	8	48	40	30	3
K0676.3008X050	M8	8	58	50	30	3
K0676.3010X020	M10	8	28	20	30	3
K0676.3010X030	M10	8	38	30	30	3