

## Hinges in die cast zinc with clamping function

### Item description/product images



### Description

#### Material:

Hinge in die cast zinc; axle in steel; clamping lever glass-fibre reinforced thermoplastic; mechanics in steel

#### Surface finish:

Hinge black powder-coated; axle galvanized; clamping lever black; mechanics black galvanized

#### Note:

The hinges can be clamped in every position due to adjustable clamping lever. The hinges are available with or without guide tabs for aluminium profiles.

### Drawings

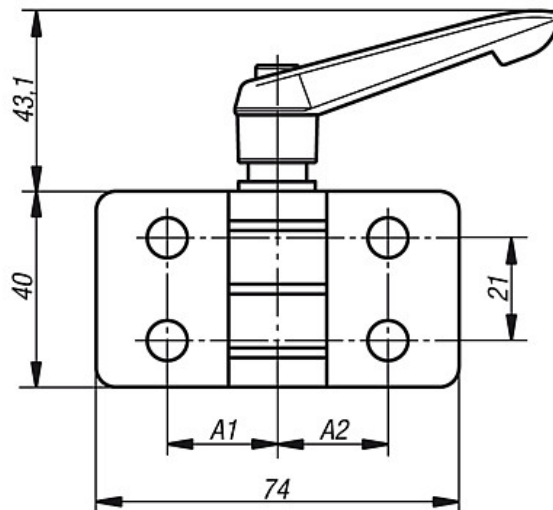
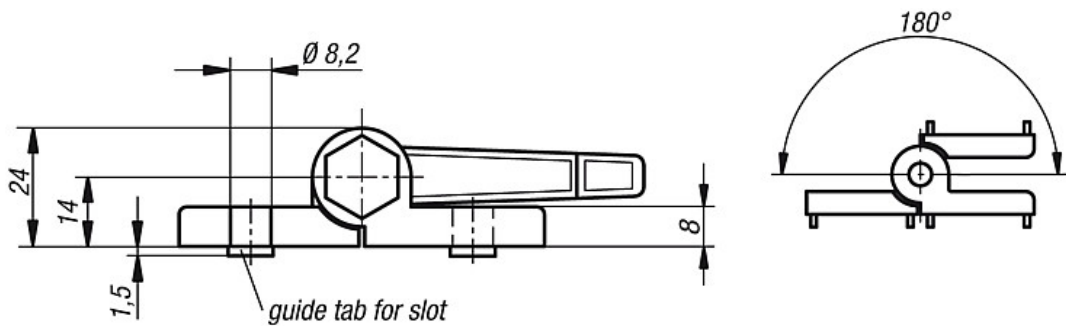

## Hinges in die cast zinc with clamping function

### Overview of items

Order No.	A1	A2	Guide tabs for slot	Load bearing capacity N
K0442.40232300	22,5	22,5	-	2500
K0442.40232308	22,5	22,5	8	2500
K0442.40232310	22,5	22,5	10	2500
K0442.40232500	22,5	25	-	2500
K0442.40232508	22,5	25	8	2500
K0442.40232510	22,5	25	10	2500
K0442.45252500	25	25	-	2500
K0442.45252508	25	25	8	2500
K0442.45252510	25	25	10	2500