

Magnets deep pot AlNiCo with fitting tolerance

Item description/product images

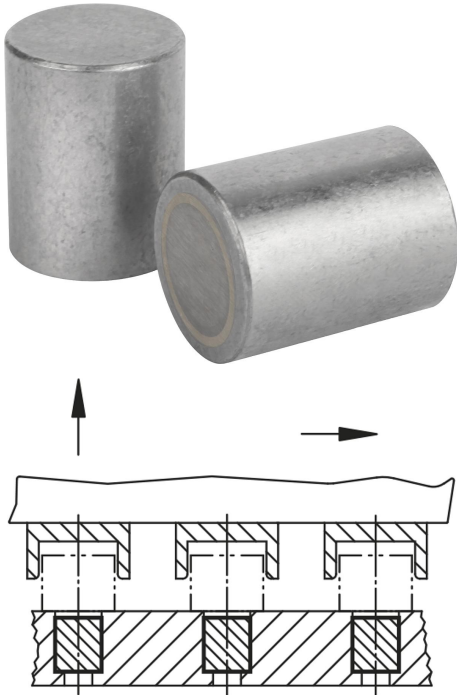

Description

Material:

Housing, steel.
Magnetic core AlNiCo.

Version:

Housing bright.

Note:

Shielded system. Diameter "D" ground to a h6 tolerance. Fastening possibilities by press-in, shrink-fit or gluing.
Deep pot magnets can be shortened by the dimension "H1" with no loss of magnetic force.

Temperature range:

max. 450°C.

Drawing reference:

1) magnetic face

Drawings

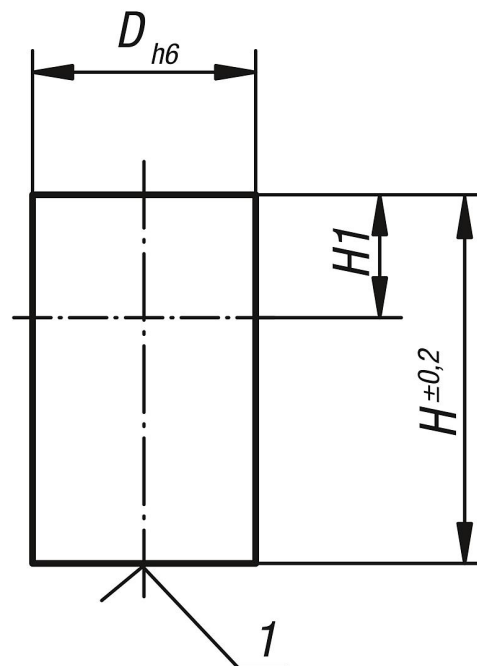

Overview of items

Magnets deep pot AlNiCo with fitting tolerance

Magnets deep pot AlNiCo with fitting tolerance

Overview of items

Order No.	D	H	H1	Magnetic force N
K0545.01	6	10	2	1,5
K0545.02	8	12	3	3,5
K0545.03	10	16	6	7
K0545.04	13	18	7	10
K0545.05	16	20	5	18
K0545.06	20	25	6	42
K0545.07	25	30	5	96
K0545.08	32	35	3	180
K0545.09	40	45	5	240
K0545.10	50	50	2	420