

# Vertical Toggle Clamp

Part No. GH-15501-C

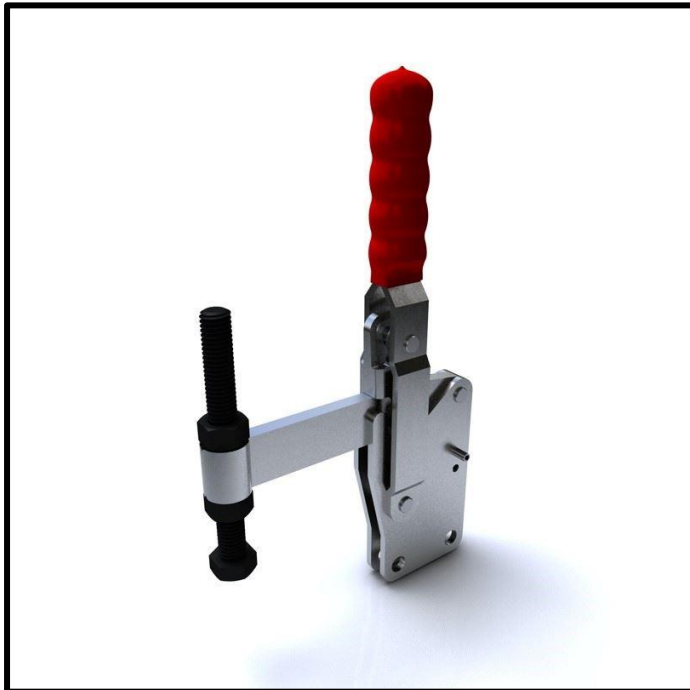

## Product Description

Vertical Toggle Clamp Straight  
Base Fixed Arm Size 550Kg

## Key Features

Overall Height: 335mm  
Underarm Height: 100.8mm  
Arm Length: 107.8mm  
Holding Force: 550Kg

## Other Features

Arm Opens: 100°  
Handle Opens: 50°  
Weight: 2.4Kg

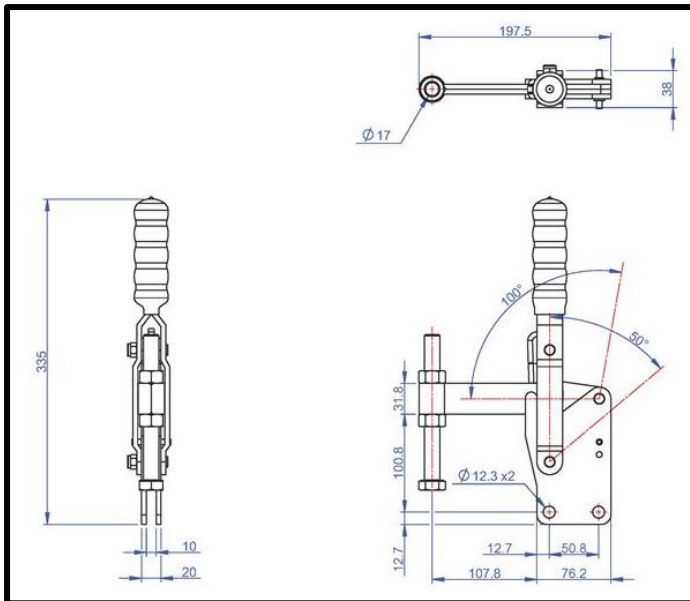

## Material

Clamp: Zinc Plated Mild Steel  
Spindle: Zinc Plated Mild Steel  
Handle: uPVC

## What's In The Bag?

GH-15501-C: Toggle Clamp  
SA-161520: M16x150mm Zinc Plated Steel  
Spindle With Nuts



[goodhanduk.co.uk](http://goodhanduk.co.uk)

01908 221 151