

► Light Duty - with a Pulling Latch

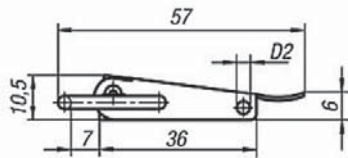

TOGGLE LATCHES

Form A



Form B

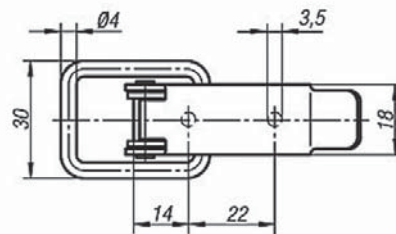
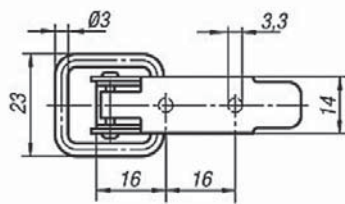
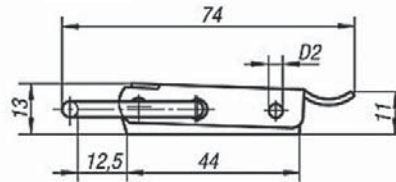

TOGGLE LATCHES IN STEEL

Part No	Form	D2	Holding Force
GH-44.1330571	A	2.8	100Kg
GH-44.2350741	B	3.2	200Kg

TOGGLE LATCHES IN STAINLESS STEEL

Part No	Form	D2	Holding Force
GH-44.1330572	A	2.8	100Kg
GH-44.2350742	B	3.2	200Kg

LATCH PLATES

Latch Plate - Form A

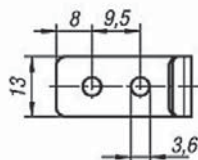
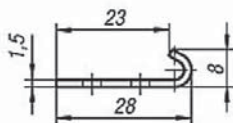

Latch Plate - Form A

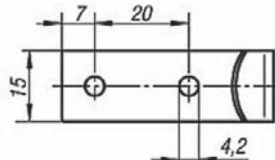
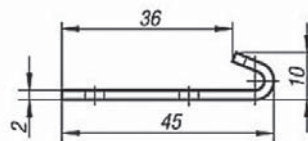

LATCH PLATES IN STEEL

Part No	Form
GH-44.9136281	A
GH-44.9242451	B

LATCH PLATES IN STAINLESS STEEL

Part No	Form
GH-44.9136282	A
GH-44.9242452	B