

Latch Toggle Clamp

Part No. GH-40380-R



Product Description

Safety Lock Latch Toggle Clamp
With Latch Plate Size 3400daN

Key Features

Overall Height: 93.8mm
Clamp Length: 187.7mm
Catch Plate Width: 79.4mm
Holding Force: 3400daN

Other Features

Weight: 1.61Kg
Safety Lock

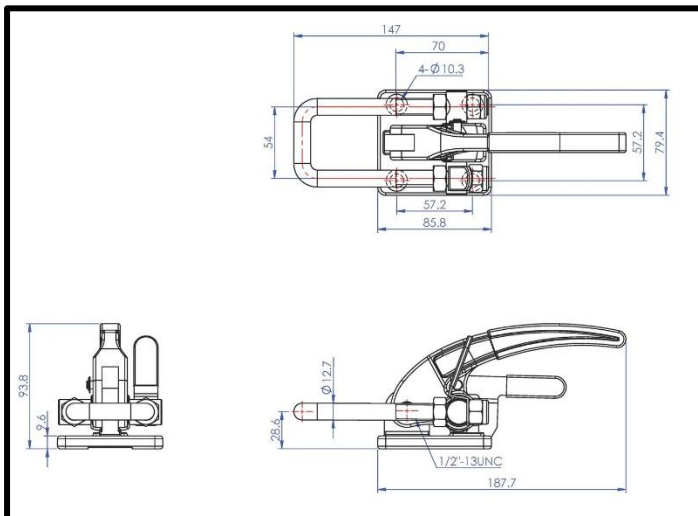

Material

Toggle Clamp: Zinc Plated Mild Steel
U Bar: Zinc Plated Mild Steel
Latch Plate: Malleable Iron

What's In The Bag?

Toggle Clamp: GH-40380-R
Latch Plate: GH-40370-LP
U Bar: GH-40380-UB



goodhanduk.co.uk

01908 221 151