

Vertical Toggle Clamp

Part No. GH-12502-B

GH GoodHand UK



Product Description

Vertical Toggle Clamp Flat Base
Slotted Arm Size 250Kg

Key Features

Overall Height: 178mm
Underarm Height: 32mm
Arm Length: 69.7mm
Holding Force: 250Kg

Other Features

Arm Opens: 90°
Handle Opens: 70°
Weight: 0.44Kg

Material

Clamp: Zinc Plated Mild Steel
Spindle: Zinc Plated Mild Steel
Handle: uPVC

What's In The Bag?

GH-12502-B: Toggle Clamp
2x FW-516: Flanged Washers For 8mm Spindle
SA-086512: M8x65mm Neoprene Tipped Spindle
With Nuts

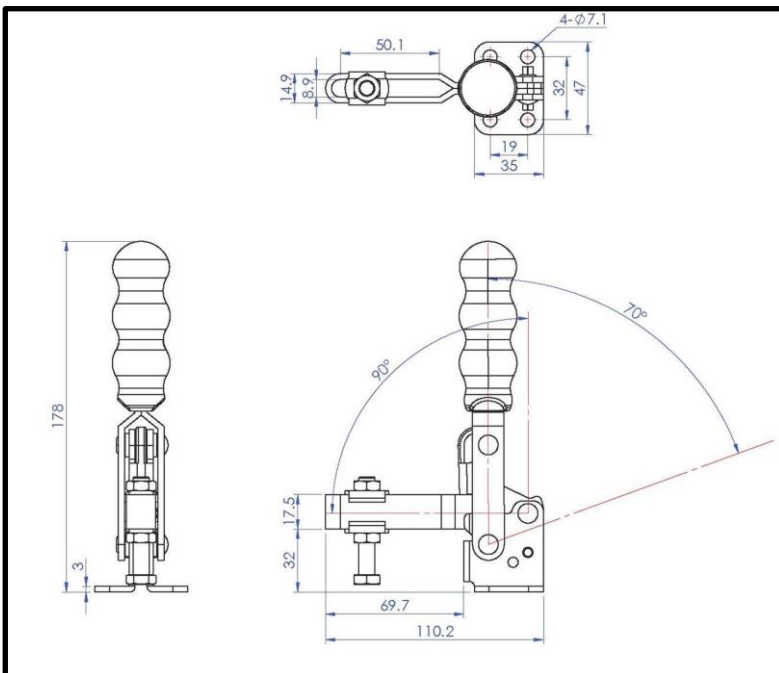

GH GoodHand UK

goodhanduk.co.uk

01908 221 151