

Hinges aluminium, lift-off, right

Item description/product images



Description

Material:

Die-cast aluminium.
Hinge pin stainless steel.

Version:

Hinge silver powder coated.
Axle bright.

Note:

Hinges for panel elements and aluminium profiles.
The hinges can be fitted with a plastic spacer ring on the hinge pin.

On request:

Hinges with guide tabs for aluminium profiles (slots 5, 6, 8, 10, 12 and 14).
Unequal leaf combinations.

Drawings

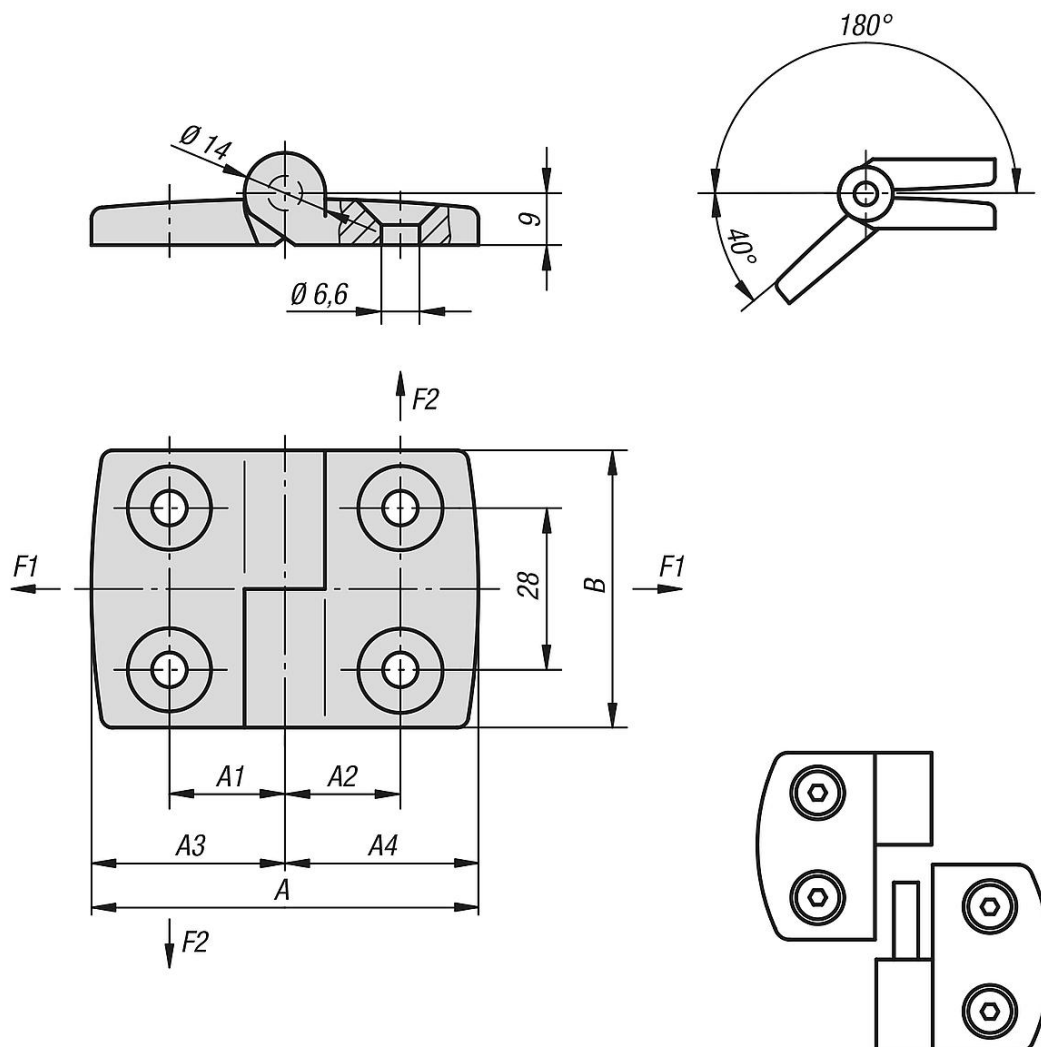

Hinges aluminium, lift-off, right

Overview of items

Hinges aluminium, lift-off, right

Order No.	A	A1	A2	A3	A4	B	F1 max. kN	F2 max. kN
K0579.2251515	52	15	15	26	26	48	0,41	0,25
K0579.2301818	59	17,5	17,5	29,5	29,5	48	0,45	0,28
K0579.2352020	72	20	20	36	36	48	0,5	0,25
K0579.2402323	77	22,5	22,5	38,5	38,5	48	0,55	0,2
K0579.2452525	87	25	25	43,5	43,5	48	0,55	0,2
K0579.2502828	97	27,5	27,5	48,5	48,5	48	0,55	0,175
K0579.2603333	115	32,5	32,5	57,5	57,5	48	0,575	0,15