

Vertical Toggle Clamp

Part No. GH-14501-C

GH GoodHand **UK**

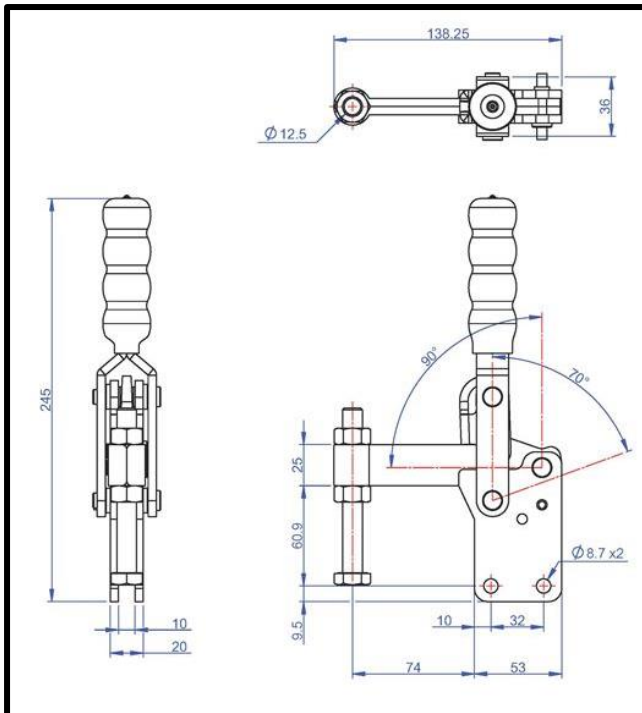
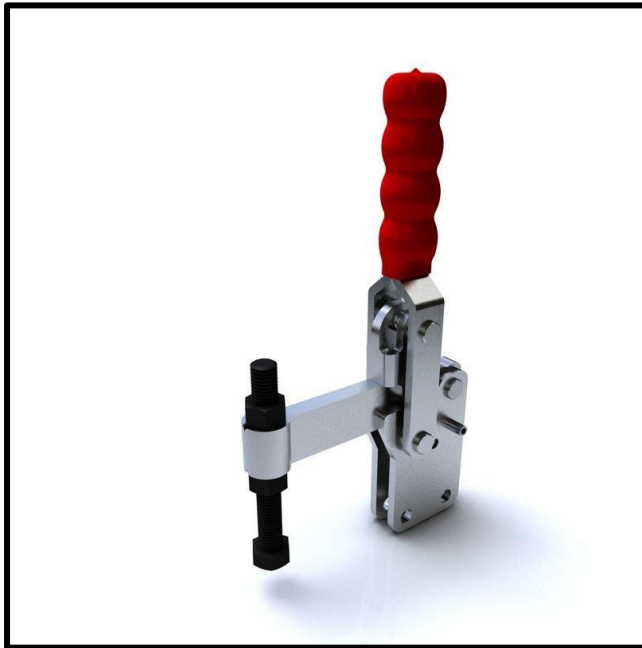

Product Description

Vertical Toggle Clamp Straight
Base Fixed Arm Size 450Kg

Key Features

Overall Height:	245mm
Underarm Height:	60.9mm
Arm Length:	74mm
Holding Force:	450Kg

Other Features

Arm Opens:	90°
Handle Opens:	70°
Weight:	1.2Kg

Material

Clamp:	Zinc Plated Mild Steel
Spindle:	Zinc Plated Mild Steel
Handle:	uPVC

What's In The Bag?

GH-14501-B: Toggle Clamp
SA-121017: M12x100mm Zinc Plated Steel
Spindle With Nuts

GH GoodHand **UK**

goodhanduk.co.uk

01908 221 151