

## Spring Toggle Latches Part No. CT-19105



### Product Description

Spring Toggle Latch With Catch Plate Zinc  
Plated L=76mm

### Key Features

Overall Length: 76mm  
Load Capacity: 22daN

### Other Features

Weight: 0.023Kg

### Material

Toggle Latch: Zinc Plated Steel

### What's In The Bag?

Toggle Latch: CT-19105  
Latch Plate: CT-22-2

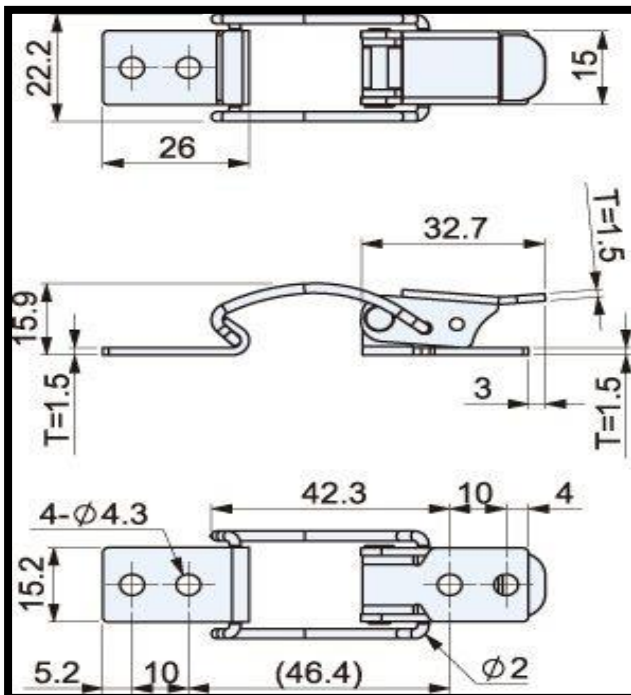

[goodhanduk.co.uk](http://goodhanduk.co.uk)

01908 221 151