

# Vertical Toggle Clamp

Part No. GH-12055-U

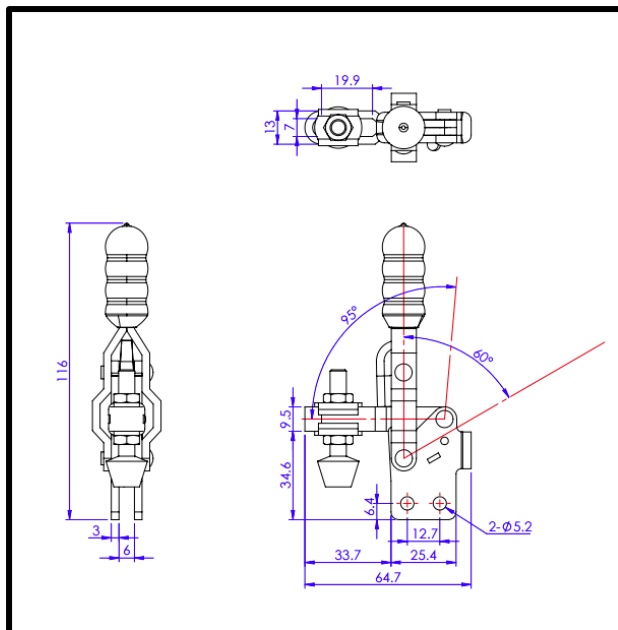
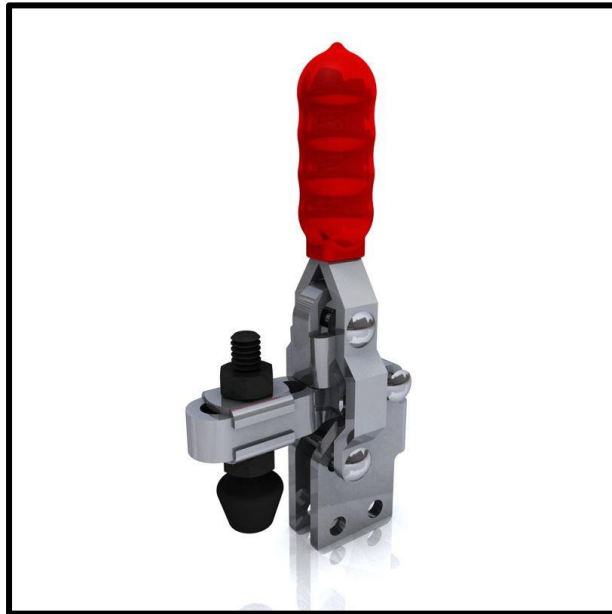

## Product Description

Vertical Toggle Clamp Straight  
Base Slotted Arm Size 91Kg

## Key Features

Overall Height: 116mm  
Underarm Height: 34.6mm  
Arm Length: 33.7mm  
Holding Force: 91Kg

## Other Features

Arm Opens: 95°  
Handle Opens: 60°  
Weight: 0.17Kg

## Material

Clamp: Zinc Plated Mild Steel  
Spindle: Neoprene Tipped Steel  
Handle: uPVC

## What's In The Bag?

GH-12055-U: Toggle Clamp  
FC-064410: M6x44mm Neoprene Tipped Steel  
Spindle With Nuts  
2x FW-142: Flanged Washers for M6 Spindle