

Vertical Toggle Clamp

Part No. GH-11002-B

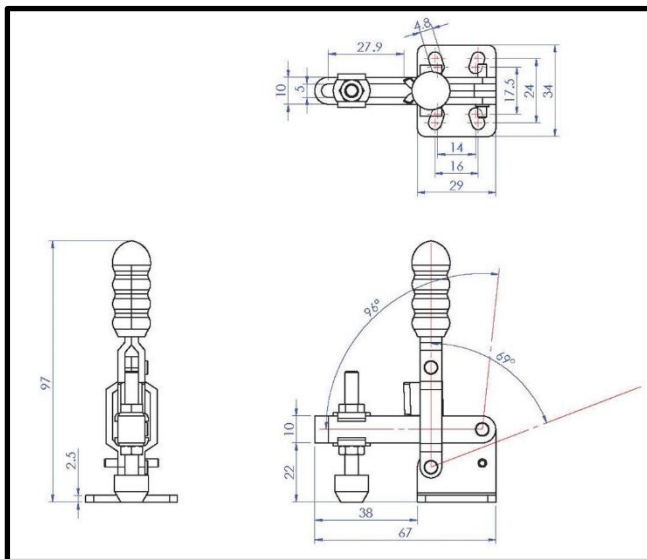

Product Description

Vertical Toggle Clamp Flat Base
Slotted Arm Size 100Kg

Key Features

Overall Height: 97mm
Underarm Height: 22mm
Arm Length: 38mm
Holding Force: 100Kg

Other Features

Arm Opens: 96°
Handle Opens: 69°
Weight: 0.08Kg

Material

Clamp: Zinc Plated Mild Steel
Spindle: Zinc Plated Mild Steel
Handle: uPVC
Neoprene Cap: Neoprene

What's In The Bag?

GH-11002-B: Toggle Clamp
2x FW-100: Flanged Washers For 5mm Spindle
SA-054008: M5x40mm Spindle With Nuts
NC-05: Neoprene Cap for Spindle



goodhanduk.co.uk

01908 221 151