

# Vertical Toggle Clamp

Part No. GH-12135

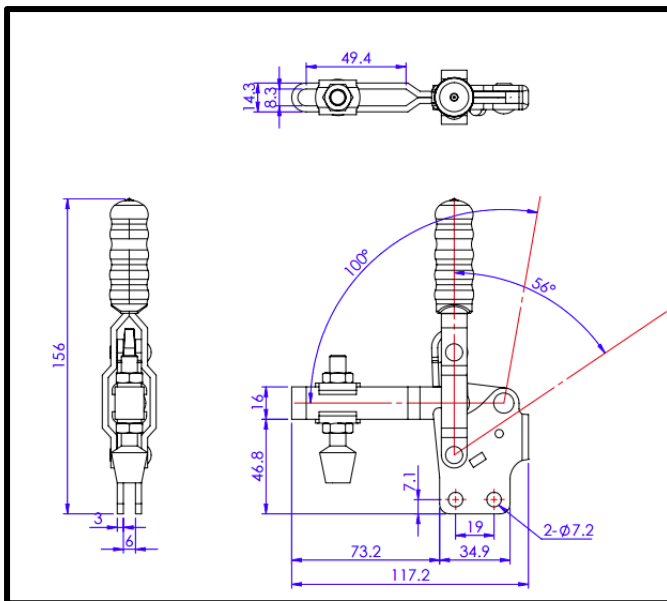

## Product Description

Vertical Toggle Clamp Straight  
Base Slotted Arm Size 227Kg

## Key Features

Overall Height: 156mm  
Underarm Height: 46.8mm  
Arm Length: 93.2mm  
Holding Force: 227Kg

## Other Features

Arm Opens: 100°  
Handle Opens: 56°  
Weight: 0.355Kg

## Material

Clamp: Zinc Plated Mild Steel  
Spindle: Neoprene Tipped Steel  
Handle: uPVC

## What's In The Bag?

GH-12135: Toggle Clamp  
FC-086312: M8x63mm Neoprene Tipped Steel  
Spindle With Nuts  
2x FW-516: Flanged Washers for M8 Spindle



[goodhanduk.co.uk](http://goodhanduk.co.uk)

01908 221 151