

Solid Arm Toggle Latches

Part No. CS-0810



Product Description

Solid Arm Latch Without Catch Plate
Stainless Steel L= 155mm

Key Features

Overall Length: 155mm
Load Capacity: 50daN

Other Features

Weight: 0.199Kg

Material

Toggle Latch: Stainless Steel

What's In The Bag?

Toggle Latch: CT-0810

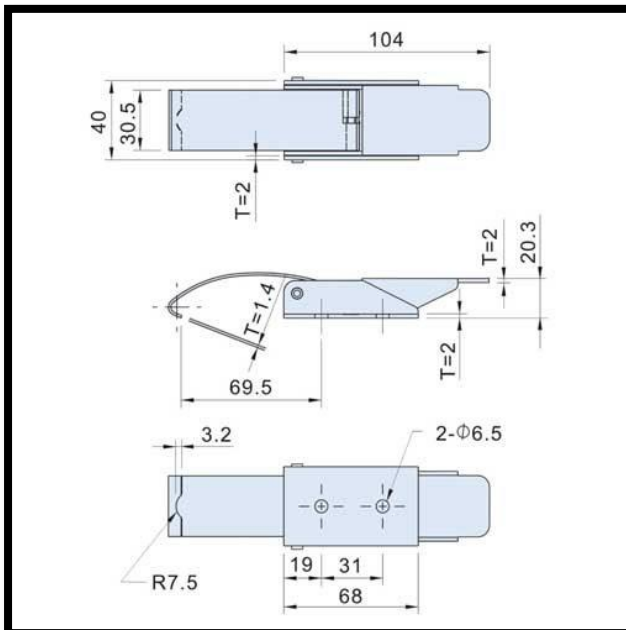

goodhanduk.co.uk

01908 221 151