

Heavy Duty Vertical Toggle Clamp

Part No. GH-72420

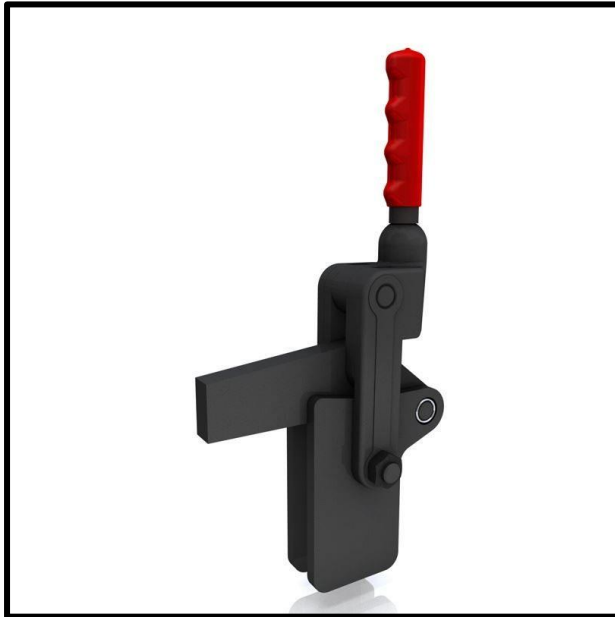

Product Description

Heavy Duty Toggle Clamp Straight
Base Solid Arm Size 2400daN

Key Features

Overall Height:	325mm
Underarm Height:	105mm
Arm Length:	60mm
Holding Force:	2400daN

Other Features

Arm Opens:	195°
Handle Opens:	130°
Weight:	3.912Kg

Material

Toggle Clamp:	Cast Iron
Spindle:	Zinc Plated Mild Steel
Handle:	uPVC

Whats In The Bag?

Toggle Clamp:	GH-72420
Spindle:	SA-161520

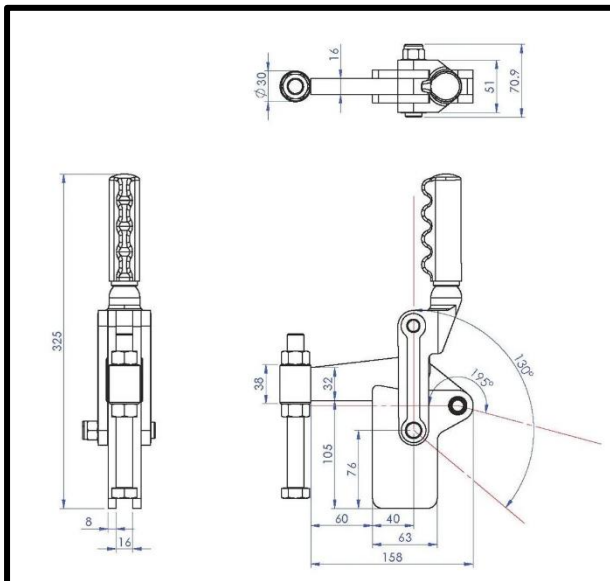

goodhanduk.co.uk

01908 221 151