

Vertical Toggle Clamp

Part No. GH-12145

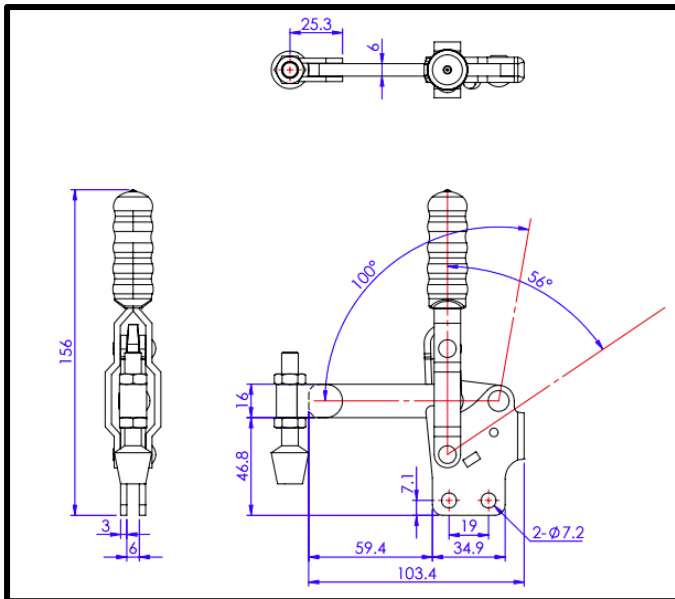
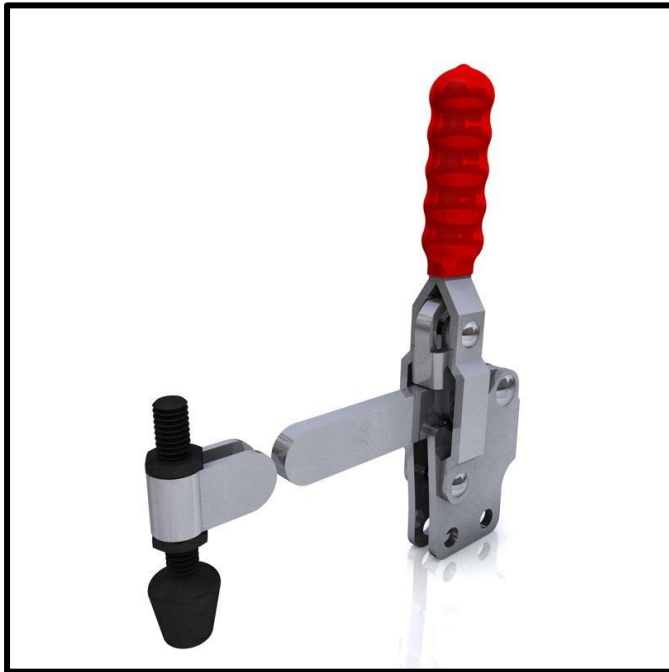

Product Description

Vertical Toggle Clamp Straight
Base Solid Arm Size 227Kg

Key Features

Overall Height: 156mm
Underarm Height: 46.8mm
Arm Length: 59.4mm
Holding Force: 227Kg

Other Features

Arm Opens: 100°
Handle Opens: 56°
Weight: 0.34Kg

Material

Clamp: Zinc Plated Mild Steel
Spindle: Neoprene Tipped Steel
Handle: uPVC
Bolt Retainer: Zinc Plated Mild Steel

What's In The Bag?

GH-12145: Toggle Clamp
FC-086312: M8x63mm Neoprene Tipped Steel
Spindle With Nuts
BR-516: Bolt Retainer For M8 Spindle



goodhanduk.co.uk

01908 221 151